

CENTER PIVOT COMPONENTS



RELIABLE

DURABLE

ADVANCED

RESPONSIVE

SUSTAINABLE



*◀◀ We want to simplify the life of those caring for crops, for work, and for passion.
We work so that every irrigation system is used wisely, providing sustainable value
to the agriculture. ▶▶*

** Web.: www.raintekglobal.com

** Email: sales@raintekglobal.com

** Tel.: +86 574 8787 8639

** WhatsApp / WeChat: +86 188 5805 4574

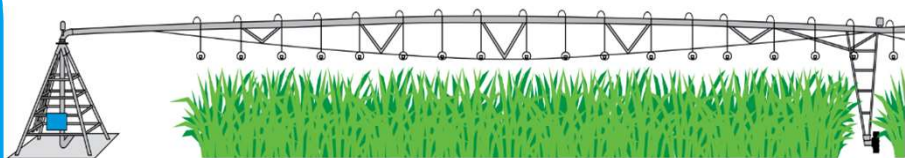

PSG35 Series Center Drive

The most efficient gear motor for center pivot and linear irrigation system!

RainTek dual voltage electric motor, available in 3 phase is designed to work with global power sources. When coupled with our wide range of speed reducing gear ratios, the grower is able to precisely control water application while saving energy.



Specifications

Product Number	PSG35-RTUMC20	PSG35-RTUMC25	PSG35-RTUMC30	PSG35-RTUMC40	PSG35-RTUMC50
Ratio	20:1	25:1	30:1	40:1	50:1
Motor HP	1-1/2 HP	1-1/2 HP	1-1/2 HP	3/4 HP	3/4 HP
Service Factor	1.1	1.1	1.1	1.3	1.3
Full Load RPM	460 / 380	460 / 380	460 / 380	460 / 380	460 / 380
** Input	1745 / 1425 RPM	1745 / 1425 RPM	1745 / 1425 RPM	1745 / 1425 RPM	1745 / 1425 RPM
** Output	87 / 71 RPM	67 / 55 RPM	58 / 48 RPM	44 / 35 RPM	35 / 29 RPM
Full Load AMP	2.4 A / 2.7 A	2.4 A / 2.7 A	2.4 A / 2.7 A	1.4 A / 1.5 A	1.4 A / 1.5 A
No Load AMP	1.3 A / 1.4 A	1.3 A / 1.4 A	1.3 A / 1.4 A	1.0 A / 1.1 A	1.0 A / 1.1 A

■ **High-Speed**

■ **Standard-Speed**

Dimensional Drawing

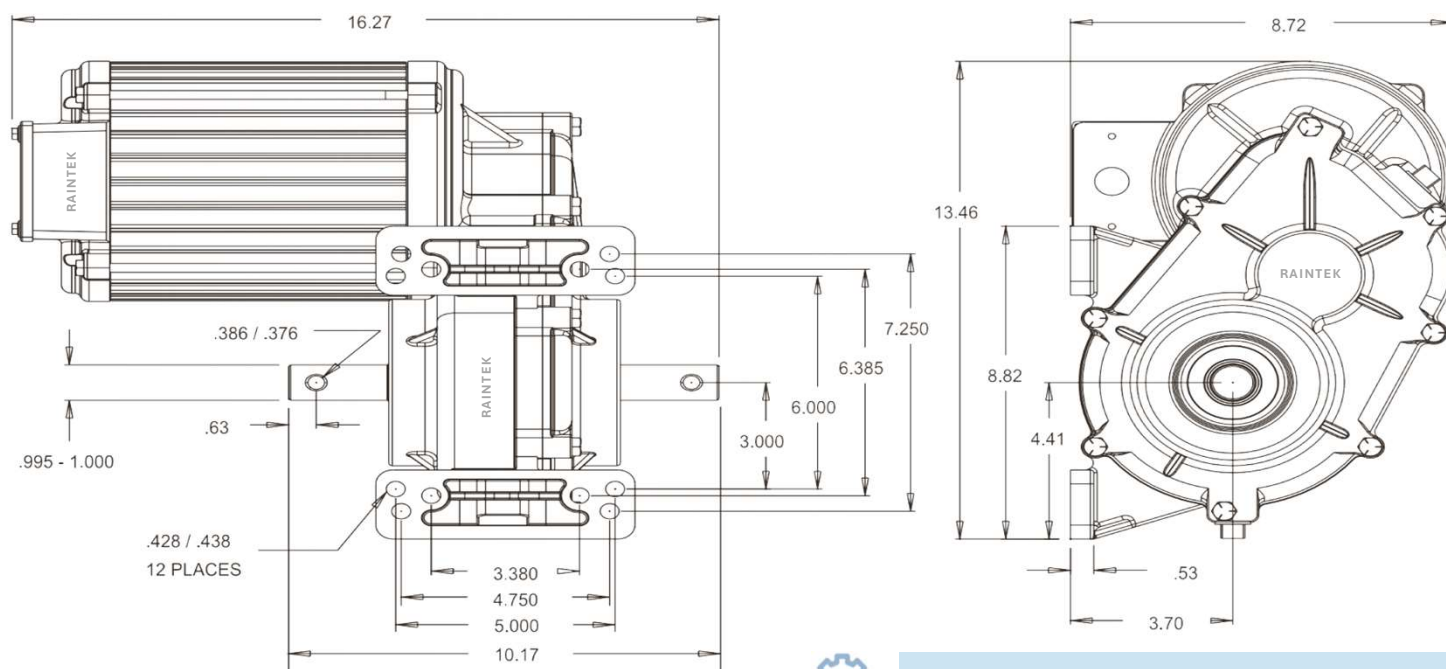

Universal Interface:

RainTek center drives' multiple mounting bolt patterns enabling to interface with nearly all brands pivot: Valmont (Valley), Lindsay (Zimmatic), Reinke, Western....

RTGM Series Center Drive

The most cost-effective drives in the pivot irrigation industry!

The RTGM series are using 25 degree pressure angle tooth form which provides greater tooth load carrying capacity. The upgraded water-tight seals between housing parts provide a better protection. Regardless of speed and torque requirements, RTGM series are designed to get the job done.



Specifications

Product Number	RTGM7540	RTGM7550	RTGM1040	RTGM1050	RTGM1530	RTGM1540	RTGM1550
Ratio	40:1	50:1	40:1	50:1	30:1	40:1	50:1
Motor HP	3/4 HP	3/4 HP	1.0 HP	1.0 HP	1-1/2 HP	1-1/2 HP	1-1/2 HP
Service Factor	1.0	1.0	1.0	1.0	1.0	1.0	1.0
Full Load RPM	460 / 380	460 / 380	460 / 380	460 / 380	460 / 380	460 / 380	460 / 380
** Input	1750 / 1455	1750 / 1455	1750 / 1455	1750 / 1455	1750 / 1455	3400 / 2800	3400 / 2800
** Output	43 / 35 RPM	34 / 28 RPM	43 / 35 RPM	34 / 28 RPM	57 / 47 RPM	86 / 70 RPM	68 / 56 RPM
Full Load AMP	1.4 A / 1.5 A	1.4 A / 1.5 A	1.9 A / 2.1 A	1.9 A / 2.1 A	2.3 A / 2.6 A	2.4 A / 2.7 A	2.4 A / 2.7 A
No Load AMP	1.0 A / 1.1 A	1.0 A / 1.1 A	1.2 A / 1.3 A	1.2 A / 1.3 A	1.2 A / 1.3 A	1.3 A / 1.4 A	1.3 A / 1.4 A

■ Standard-Speed

■ High-Speed

Dimensional Drawing

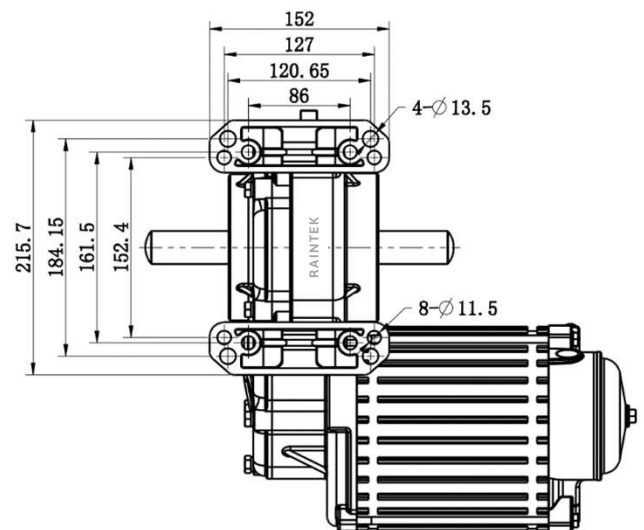
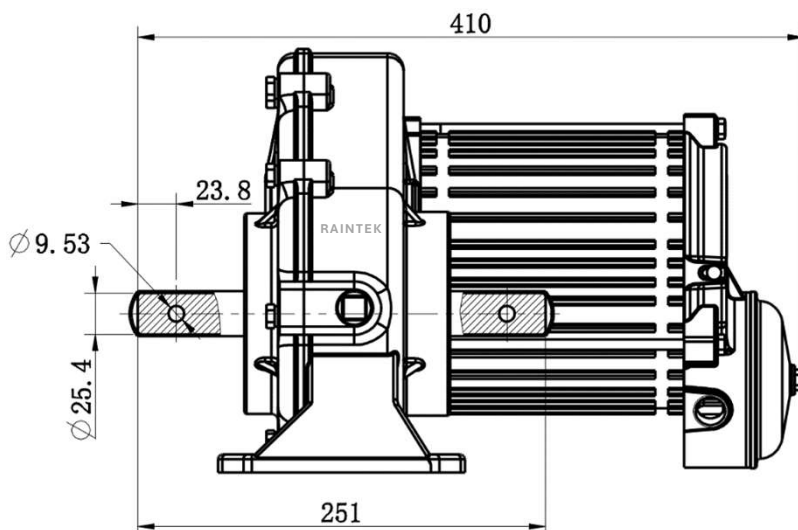

Wide Range of Options:

RainTek offers the widest range of center drives in the pivot irrigation industry, standard-speed, medium-speed, and high-speed. Regardless of speed and torque requirements, we have a center drive designed to get the job done.

<< Why Choose RainTek Center Drives? >>

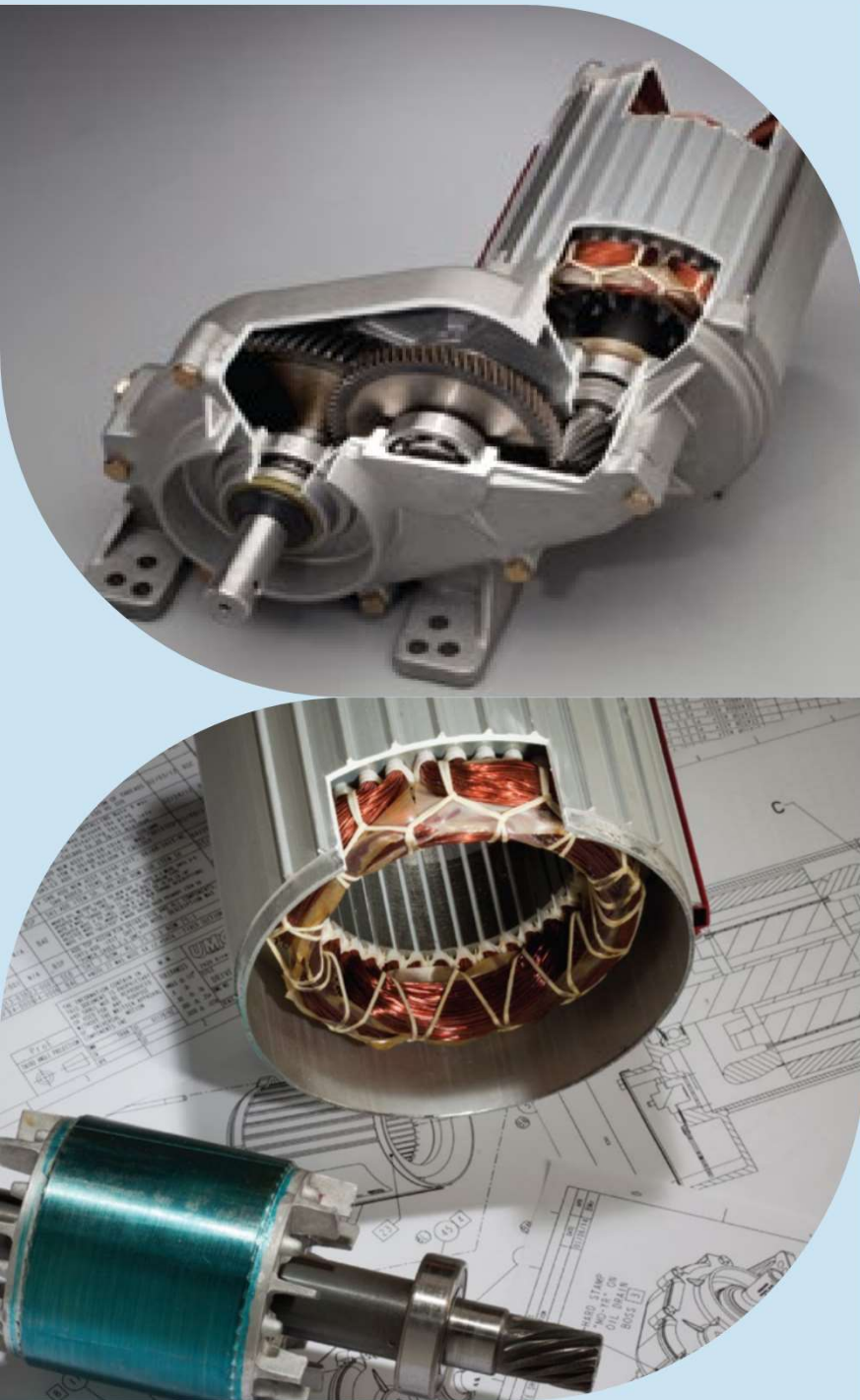

Enhanced Sealing:

RainTek center drives feature cartridge style output seals which eliminate shaft grooving and reduce oil leaks. The special design can reduce the maintenance costs.



Robust Design:

All the center drives feature superior protection from water ingress as well as larger bearings and precision machined heat-treated forged steel gears.



Excellent Quality:

All the RainTek center drives are well designed, carefully crafted, and using top-grade materials, the advance manufacturing methods ensure the quality and field life.



Universal Interface:

Different pivot manufacturers are using different mounting patterns, RainTek center drives are using multiple mounting bolt patterns enabling them to interface with nearly every pivot brand.

Today RainTek offers the widest range of center drives in the irrigation industry designed for everything from standard speed irrigation to super high speed chemigation and data collection. For over 13 years, our center drives have been the trusted choice of customers worldwide.



740 Series Pivot Wheel Gearbox *Standard-Duty*

RainTek 740 series gearboxes have been the industry standard used on many center pivot and lateral / linear irrigation systems globally for decades. They are capable of handling nearly any field conditions. Many growers like the versatility as it allows for operating in conditions where wheel ruts may exist, soil can be heavy and terrain is uneven. All the 740 series gearboxes can only be fitted to standard-speed center drive, if the users are using high-speed center drive, please choose our 760 series.

Number: RTUMC740-U

 **50:1 Gear Ratio**

 **Short Neck**

- 2.25" (5.72cm) Output Shaft;
- Cartridge Input and Output Seals;
- Larger Input Bearing;
- Input Shaft Guard;
- External Seal Protection for Seals;
- Top Oil Fill Plug;
- 11-Bolt Mounting Pattern;
- Full Cycle Expansion Chamber with Stainless Steel Cover;
- Filled with Extreme Pressure Worm Gear Oil;
- Steel Output Shaft and Ductile Iron Input Shaft;
- Tapered Roller Bearings;
- Thick Output Flange Plate;
- Standard-Duty;
- Upgraded Gear Teeth;
- Include Carriage Bolts and Nuts;
- Dual Ended Input Shaft;

Number: RTUMC740-UV

 **52:1 Gear Ratio**

 **Long Neck**

Dimensional Drawing

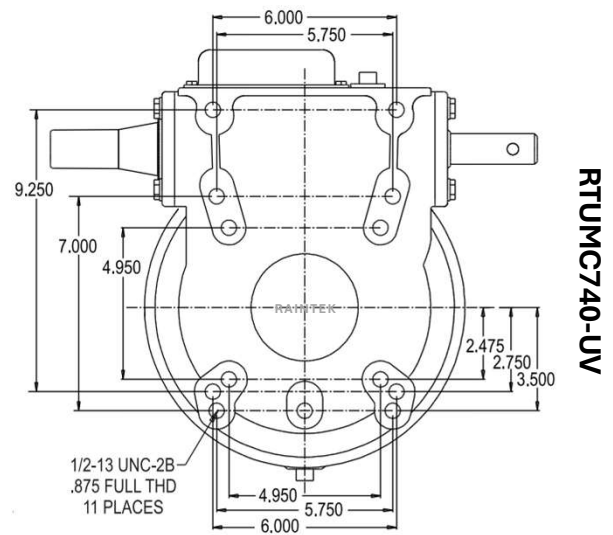
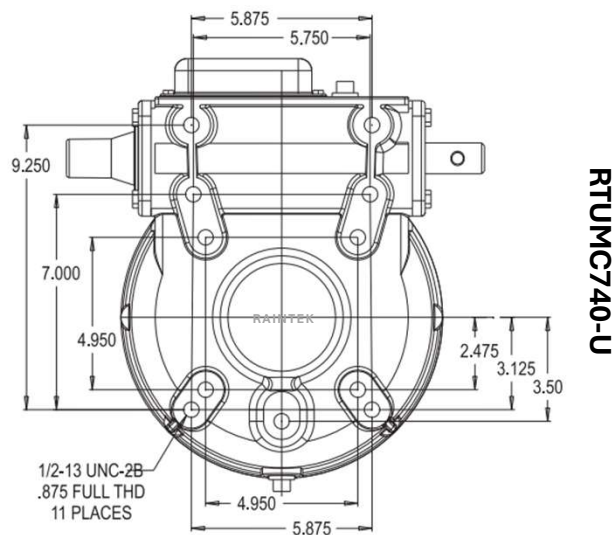

760 Series Pivot Wheel Gearbox *Heavy-Duty*

RainTek 760 series gearboxes are designed for the most extreme applications. It features a larger-diameter bull gear than the standard 740 series to handle around 20% more torque. The 760 series are suitable for a higher annual hours of operation while handling the heavy loads experienced on corner arm and lateral / linear cart as well as the most extreme field conditions where wheel rutting is prominent, soil is heavy, and tower weights are higher.

Number: RTUMC760-U

 **50:1 Gear Ratio**

 **Short Neck**

- 2.25" (5.72cm) Output Shaft;
 - Unique Dual Input and Output Seal;
 - 20% More Torque Capacity than 740;
 - Larger Input Bearings;
 - Input Shaft Guard;
 - External Seal Protectors for Seals;
 - 11-Bolt Mounting Pattern;
 - Full Cycle Expansion Chamber;
 - Aluminum Cover;
 - Filled with Extreme Pressure Worm Oil;
 - Steel Output and Input Shaft;
 - Tapered Roller Bearings;
 - Includes Carriage Bolt and Nut;
 - Dual Ended Input Shaft;
 - Heavy-Duty;
 - Suitable for Heavier Tower;
- 760 series are the best choice for corner arm and lateral cart.**

Number: RTUMC760-UV

 **52:1 Gear Ratio**

 **Long Neck**

Dimensional Drawing

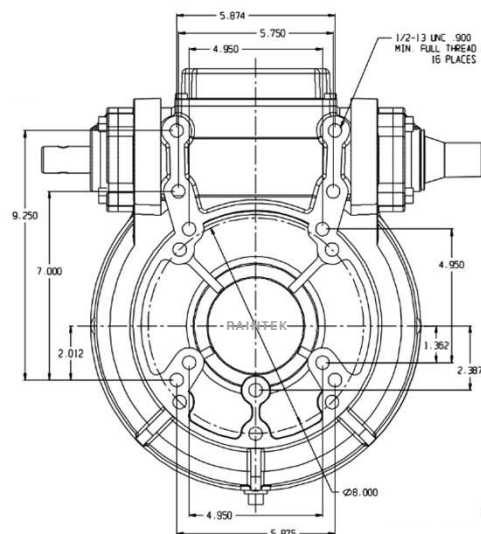

RTUMC760-U

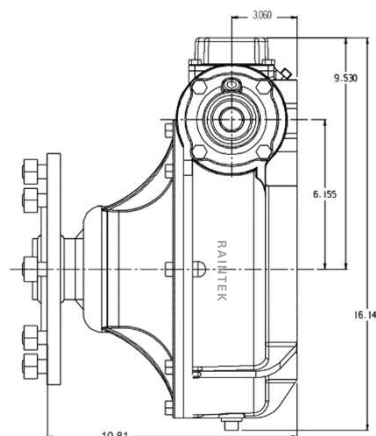

RTUMC760-UV

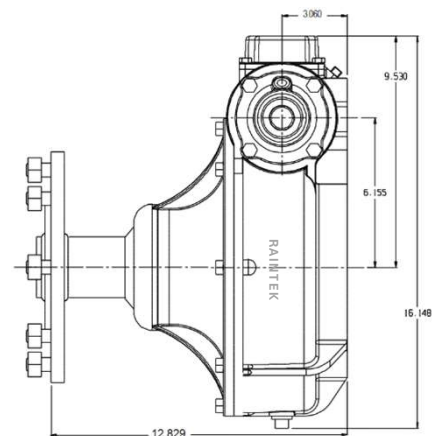

768 Series Pivot Wheel Gearbox *Leading Quality*

At RainTek, we pride ourselves on pushing the boundaries of gearbox excellence, redefining industry standards with our innovative designs and unparalleled performance. The 768 series gearboxes are meticulously crafted, purpose-built, and equipped with common sense features and premium materials, ensuring superior performance and exceptional field life. RainTek gearboxes have been the trusted choice of customers worldwide.



Number: RT768-501

 50:1 Gear Ratio

 Short Neck

- 2.25” (5.72cm) Output Shaft;
- Cartridge Input and Output Seals;
- Larger Input Bearing;
- Input Shaft Guard;
- External Seal Protection for Seals;
- Top Oil Fill Plug;
- 11-Bolt Mounting Pattern;
- Full Cycle Expansion Chamber with Stainless Steel Cover;
- Filled with Extreme Pressure Worm Gear Oil;
- Steel Output Shaft and Ductile Iron Input Shaft;
- Tapered Roller Bearings;
- Thick Output Flange Plate;
- Standard-Duty;
- Upgraded Gear Teeth;
- Include Carriage Bolts and Nuts;
- Dual Ended Input Shaft;



Number: RT768-521

 52:1 Gear Ratio

 Long Neck



Dimensional Drawing

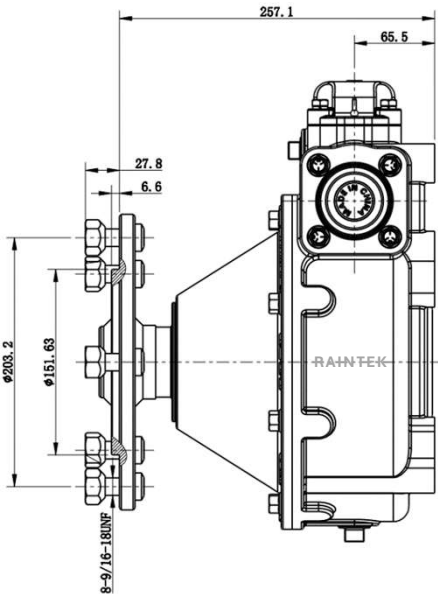

RT768-501

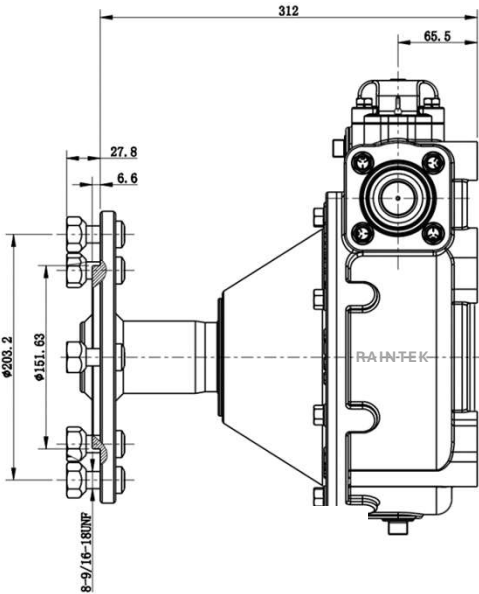

RT768-521

TNT-2 Series Towable Wheel Gearbox

RainTek TNT-2 Series are designed for applications where the irrigation system need to be towed! This gearbox is the perfect solution for a towable irrigation system. Growers typically prefer this gearbox over a gearbox with a towable hub. Simply disengage the worm and tow the system to its working location.



- 2.25" Output Shaft;
- 50:1 and 52:1 Gear Ratio;
- Cartridge Seals;
- Larger Input Bearing;
- Input Shaft Guard;
- External Seal Protection;
- Full Cycle Expansion Chamber with SS Cover;
- Filled with Extreme Pressure Worm Gear Oil;
- Steel Output Shaft and Ductile Iron Input Shaft;
- Tapered Roller Bearings;
- Include Carriage Bolts and Nuts;
- Dual Ended Input Shaft.

Dimensional Drawing

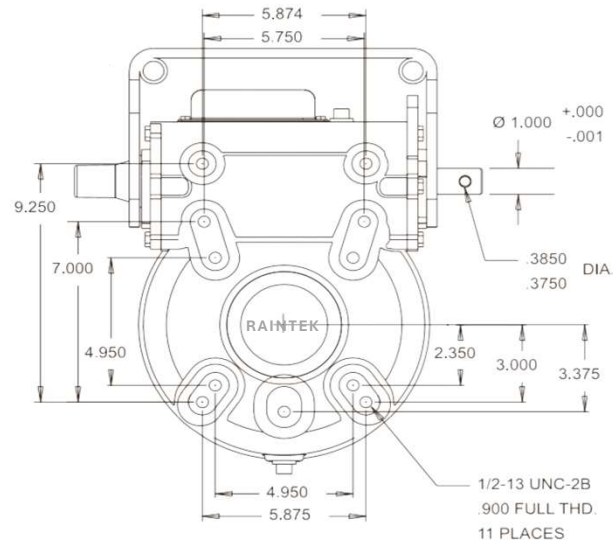
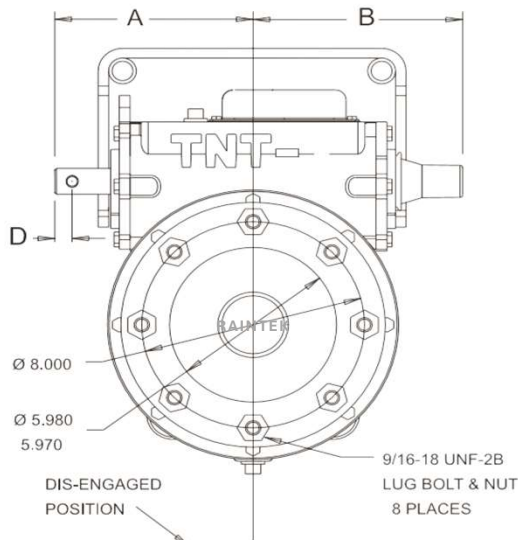

Number: RTNT-2-U

- ⚙️ **50:1 Gear Ratio**
- 🔒 **Short Neck**

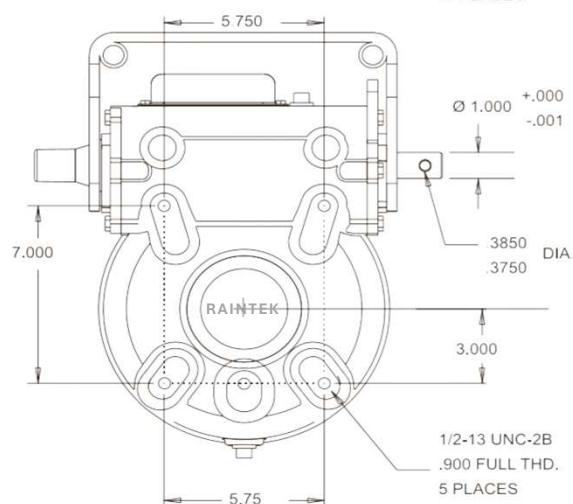
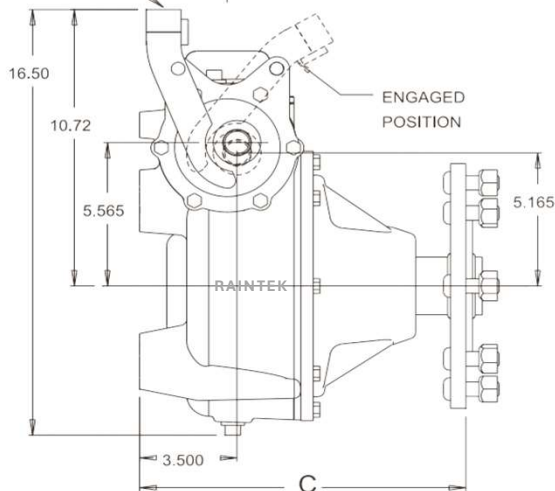

Number: RTNT-2-UV

- ⚙️ **52:1 Gear Ratio**
- 🔒 **Long Neck**

Planetary Wheel Gearbox

T-L pivot and linear systems are designed to deliver continuous movement with a special hydraulic power system. T-L planetary gears are totally enclosed and they are coupled directly to the hydraulic motor eliminating the center drive gearbox and conventional U-joints.

Product Number	Description
RT09760-115A	Gear Ratio 68:1
RT09760-115B	Gear Ratio 24:1



FEATURES

- Direct Replacement for T-L Planetary Gearboxes;
- Hydraulic Input for Direct Motor Coupling;
- Quick Acting is Standard for More Versatility;
- 24:1 or 68:1 Gear Ratio;
- 9-Bolt Wheel Flange Pattern;
- Peak Output Torque of 66,200 in-lbs;
- Filled with Lithium Grease.

Dimensional Drawing

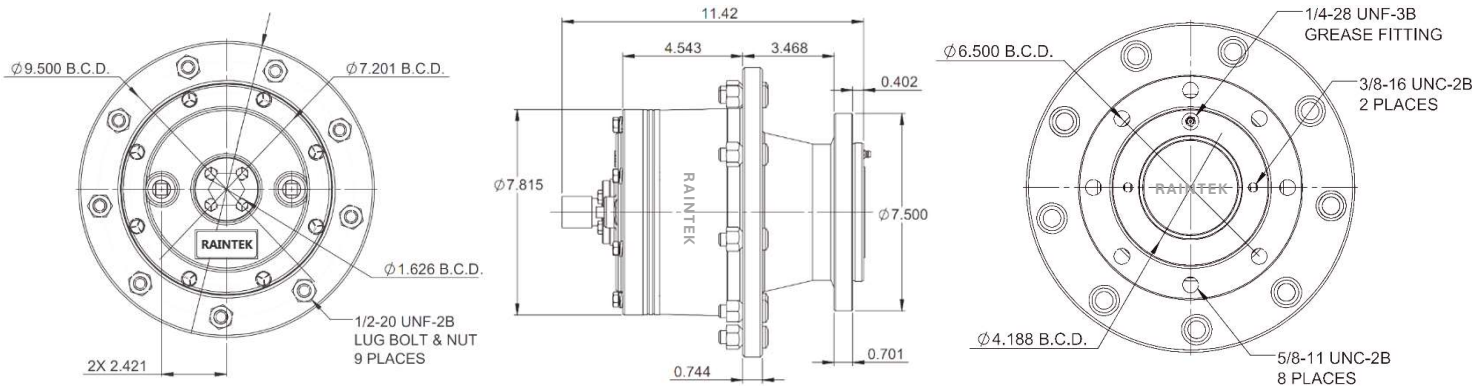

Bevel Wheel Gearbox



Special Design for Acre Master Solar Pivot

- 6:1 Ration
- Towable Design
- Bevel Gear Principle

Product Number	Description
RTAM2507L	Gear Ratio 6:1, Left Side
RTAM2507R	Gear Ratio 6:1, Right Side



Coupler

It's a shock-attenuating drive connection between the gear motor and gearbox. It features an alignment rod that helps keep concentric positioning under extreme loads. The added strength is deal in heavy soils and on systems with larger diameter tires.

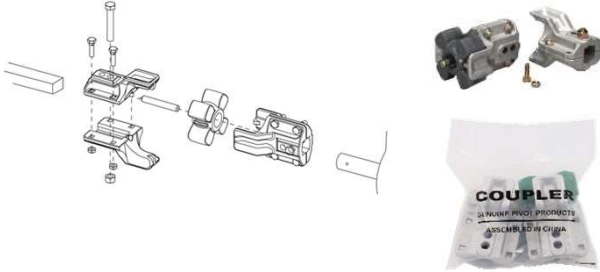

Product Number	Description
RTCPL-M78	Both Ends 1"RD. \times 7/8"SQ.
RTCPL-M34	One End 1"RD. \times 7/8"SQ., Another End 3/4"SQ. \times 3/4"SQ.

- 25 Years Service Record;
- Urethane Insert: UV and Chemical Resistant;
- Square-Neck, Hex-Head: Anti-Rotation, Faster Single-Wrench Assembly;

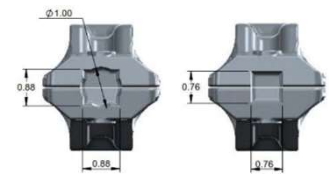

Coupler Shield



Product Number	Description
RTDL-CSGC	Grey Color, Corrugate



Product Number	Description
RTDL-CSBS	Black Color, Smooth

Drive Shaft



Product Number	Description
RTDL-DS78V	7/8" sq. \times 1.55meters, V
RTDL-DS78L	7/8" sq. \times 1.50meters, L
RTDL-DS78W	7/8" sq. \times 1.56meters, W

Drive Shaft Protector



Product Number	Description
RTDL-DSP78V	40mm \times 1.45meters, V
RTDL-DSP78L	40mm \times 1.40meters, L
RTDL-DSP78W	40mm \times 1.46meters, W

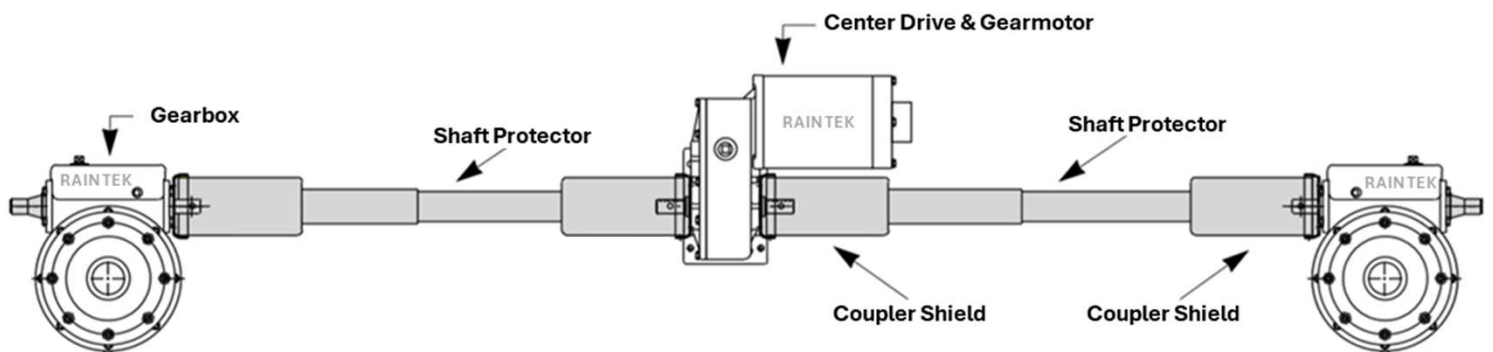

Pivot Wheel Assembly

The wheels we offer are designed specially for center pivot and linear irrigation system with an R1 pattern deep tread providing more force. RainTek offers many more tire sizes besides those shown, please contact our sales with your needs.



Product Number	Description
RTDL-WAT14246	Wheel Assembly, 14.9"×24", R1 Pattern, 6-Ply, Tyre+Tube+Rim
RTDL-WAT16246	Wheel Assembly, 16.9"×24", R1 Pattern, 6-Ply, Tyre+Tube+Rim
RTDL-WAT11246	Wheel Assembly, 11.2"×24", R1 Pattern, 6-Ply, Tyre+Tube+Rim
RTDL-WAT11386	Wheel Assembly, 11.2"×38", R1 Pattern, 6-Ply, Tyre+Tube+Rim

Non-Directional Wheel Assembly

RainTek’s non-directional tire is designed specially with a non-directional tread pattern for equal traction forward and reverse direction. It’s designed with 0 degree bar angle for less slippage than conventional tread designs resulting in reduced soil disturbance and rutting. It features a self-cleaning tread design that provides excellent traction muddy conditions.



Product Number	Description
RTDL-WAND14246	Wheel Assembly, 14.9"×24", 6-Ply, Tyre+Tube+Rim
RTDL-WAND16246	Wheel Assembly, 16.9"×24", 6-Ply, Tyre+Tube+Rim
RTDL-WAND11246	Wheel Assembly, 11.2"×24", 6-Ply, Tyre+Tube+Rim
RTDL-WAND11386	Wheel Assembly, 11.2"×38", 6-Ply, Tyre+Tube+Rim

Galvanized Rim



Product Number	Description
RTDL-GR824	Galvanized, 8"×24", used for 11.2"×24" Wheel
RTDL-GR1024	Galvanized, 10"×24", used for 11.2"×24" & 14.9"×24" Wheel
RTDL-GR1224	Galvanized, 12"×24", -2° offset, used for 14.9"×24" Wheel
RTDL-GR1038	Galvanized, 10"×38", used for 11.2"×38" Wheel, Double Plate

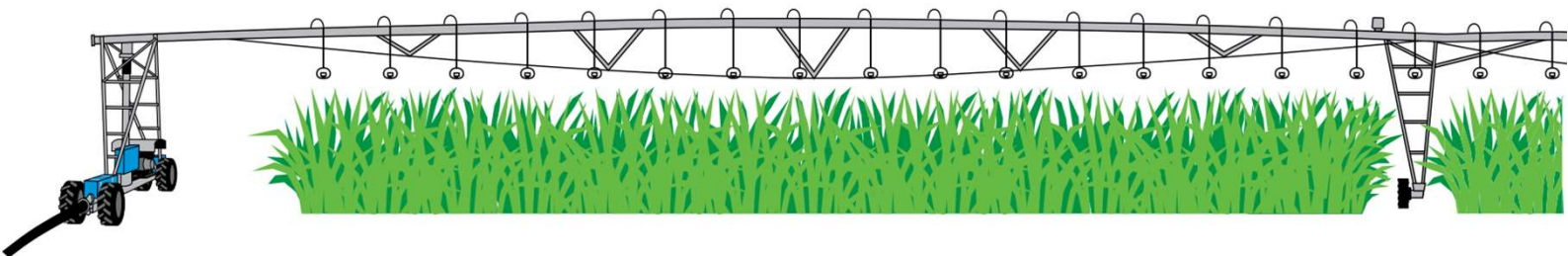

JOIN RAINTEK



Scan this QR
code to go
view our
website and
get more
information.

**SAVE WATER, SAVE ENERGY,
SAVE LABOR AND DO A BETTER
JOB OF IRRIGATION WITH
RAINTEK PRODUCTS.**



RAINTEK

No.199, Tongji Road, Jiangbei District, Ningbo, China

Tel.: +86 574 87878639 / Fax.: +86 574 88856679

sales@raintekglobal.com / raintekglobal.com

WARRANTY & DISCLAIMER: RainTek products are warranted for one year from date of original sale to be free of defective materials and workmanship when used within the working specifications for which the product was designed and under normal use and service. The manufacturer assumes no responsibility for installation, removal or unauthorized repair. The manufacturer's liability under this warranty is limited solely to replacement or repair of defective parts, and the manufacturer will not be liable for any crop or other consequential damages resulting from any defects in design or breach of warranty. THIS WARRANTY IS EXPRESSLY IN LIEU OF ALL OTHER WARRANTIES, EXPRESS OR IMPLIED, INCLUDING THE WARRANTIES OF MERCHANTABILITY AND FITNESS FOR PARTICULAR PURPOSES AND OF ALL OTHER OBLIGATIONS OR LIABILITIES OF MANUFACTURER. No agent, employee or representative of the manufacturer has authority to waive, alter or add to the provisions of warranty, nor to make representations or warranty not contained herein.