

# CENTER PIVOT COMPONENTS



RELIABLE

DURABLE

ADVANCED

RESPONSIVE

SUSTAINABLE



*◀◀ We want to simplify the life of those caring for crops, for work, and for passion.  
We work so that every irrigation system is used wisely, providing sustainable value  
to the agriculture. ▶▶*

\*\* Web.: [www.raintekglobal.com](http://www.raintekglobal.com)

\*\* Email: [sales@raintekglobal.com](mailto:sales@raintekglobal.com)

\*\* Tel.: +86 574 8787 8639

\*\* WhatsApp / WeChat: +86 188 5805 4574

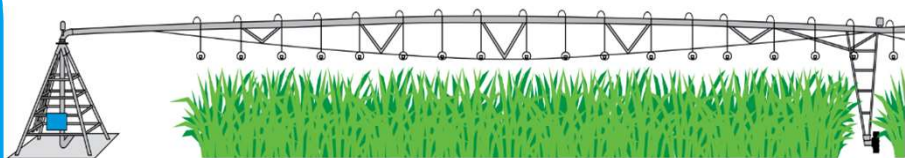



# Z2000 CONTROL PANEL



## The Most Cost-Effective Choice

Z2000 control panel is developed as a replacement of Lindsay (Zimmatic) pivot. All the electrical components are durable and selected from RainTek’s field experiences.

### FEATURES

- Hour Meter.
- Voltmeter 0-600 Volts.
- Start / Stop.
- Forward / Reverse Switch.
- Wet / Dry Switch.
- Auto-Reverse Switch.
- End Gun Switch.
- Percentage Timer.
- End Tower Running Indicator.
- Low Pressure Shutdown.
- Safety Override.



Product Number	Description
RTCPZ2000	<ul style="list-style-type: none"><li>✓ 380V, 50HZ / 418V, 60HZ, Output 110V</li><li>✓ The Installation Sizes are the Same as Lindsay Pivot</li></ul>

# COLLECTOR RING

## With Aluminum Lid



Product Number	Description
RT0315165-A10	10 Wires, 1" FNPT Connection to "J" Pipe, Aluminum Lid
RT0315165-A11	11 Wires, 1" FNPT Connection to "J" Pipe, Aluminum Lid
RT0315165-A12	12 Wires, 1" FNPT Connection to "J" Pipe, Aluminum Lid

### FEATURES

- New cover material for great impact resistance.
- Specially designed cover clamps.
- Large copper brushes are 80% copper and 20% graphite for less resistance.
- Seamless ring to reduce brush wear.
- Collector ring fits most brands center pivots.
- Wires are numbered for easy identification.
- Greaseable bearings in the base, stops shaft seizure.
- Heavy duty die cast aluminum base is more durable than the plastic base.

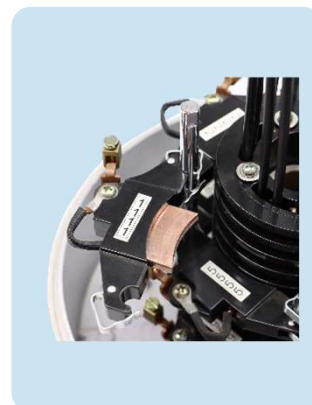

Collector Ring - Valley Style Plastic Lid



Product Number	Description
RT0315165-P10	10 Wires, 1" FNPT Connection to "J" Pipe, Plastic Lid
RT0315165-P11	11 Wires, 1" FNPT Connection to "J" Pipe, Plastic Lid
RT0315165-P12	12 Wires, 1" FNPT Connection to "J" Pipe, Plastic Lid

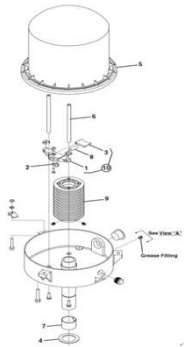

Collector Ring - Lindsay Style



Product Number	Description
RT1484960-10	10 Wires, Color Coded Wire for Easy Identification
RT1484970-11	11 Wires, Color Coded Wire for Easy Identification
RT1484980-12	12 Wires, Color Coded Wire for Easy Identification

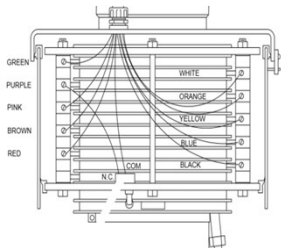

Tower Control Box

RainTek tower boxes are designed to perform smoothly and flawlessly season after season. They can withstand harsh elements. They are versatile, so they can replace virtually any tower box from any manufacturer.

Valley Style



- Heavy-Duty Galvanized Frame;
- Stainless Steel Cam and Bearing;
- High-Quality Electrical Components;
- Easy Installation.

Product Number	Description
RT22018-11	Intermediate, 11 Wires
RT22024-11	Stall, 11 Wires
RT22009-11	Last Tower, 11 Wires

Lindsay & Zimmatic Style - 2024 New Version



Product Number	Description
RT22056	Intermediate, 11 Wires
RT22057	Stall, 11 Wires
RT22058	Last Tower, 11 Wires



## Span Cable

RainTek electrical cable covers construction requirements for a multi-conductor cable designed to operate electric motor driven irrigation systems, consisting of copper conductors insulated with PVC and nylon, cabled utilizing a PVC inner jacket, and an aluminum shield bonded to a PE outer jacket offering excellent mechanical strength and moisture resistance.

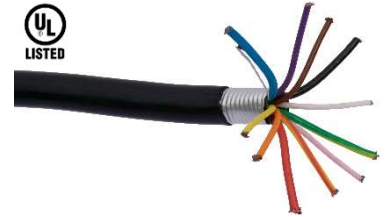

Product Number	Conductor Qty.	Description
RTEC10-1014	10	4× 10AWG+6× 14AWG, 6700 feet/roll
RTEC10-1214	10	4× 12AWG+6× 14AWG, 6700 feet/roll
RTEC10-1418	10	4× 14AWG+6× 18AWG, 6700 feet/roll
RTEC11-1014	11	4× 10AWG+7× 14AWG, 6700 feet/roll
RTEC11-1214	11	4× 12AWG+7× 14AWG, 6700 feet/roll
RTEC11-1216	11	4× 12AWG+7× 16AWG, 6700 feet/roll
<b>NOTES: CUSTOMIZED SERVICE IS AVAILABLE.</b>		

- *UL Listed;*
- *Insulation: Polyvinyl Chloride & Nylon;*
- *Polyethylene Outer Jacket;*
- *Soft Annealed Uncoated Copper Conductor;*
- *Inside Coat Aluminum Armored;*
- *Color Coding.*

## Motor Cable

Part#:	Conductor Qty.	Description
RTEC4-12	4	4× 12AWG, 6700 feet/roll
RTEC4-14	4	4× 14AWG, 6700 feet/roll

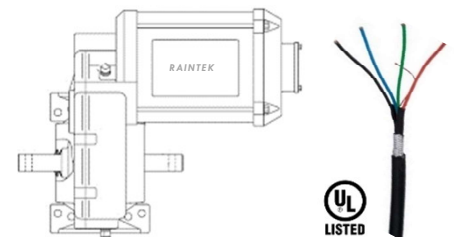

## Hour Meter



Product Number	Description
RTHM-110	110 Volts, 50 Hz

## Voltmeter



Product Number	Description
RTVM-600	0-600 VAC, Large Face

## Disconnect Switch



Product Number	Description
RTEP-DS-2	2-Pole
RTEP-DS-4	4-Pole
RTEP-DS-6	6-Pole

## Nylon Cord Connectors / Cable Gland



Product Number	Description
RTEP-NYC-13.5	PG13.5, 6-11mm×20.4mm
RTEP-NYC-16	PG16, 8-13mm×22.5mm
RTEP-NYC-21	PG21, 13-18mm×28.3mm

Percentage Timer - Eagle



Product Number	Description
RTPT-EAG-120	60 seconds, 120V, 0-100%

Percentage Timer - RainTek



Product Number	Description
RTPT-C120	60 seconds, 120V, 0-100%

Span Cable Clamps



Product Number	Description
RT11-6333-168	Galvanized, Spring Wire, 6-5/8"
RT11-6333-203	Galvanized, Spring Wire, 8"
RT11-6333-219	Galvanized, Spring Wire, 8-5/8"

Terminal Blocks



Product Number	Description
RTTB-425	4 Points, 25AMP
RTTB-625	6 Points, 25AMP
RTTB-1225	12 Points, 25AMP

Motor Cable - Tower Leg Clamps



Product Number	Description
RTMCTL-004	Galvanized, Motor Cable Holder

Panel Cable Holder - Lindsay



Product Number	Description
RTPCH-L8	Galvanized, Lindsay Pivot Point

Ground Wire Terminal



Product Number	Description
RTGT-5	5 Points, Copper, Tower Box Using

Spring - Lindsay



Product Number	Description
RTLTC-SP	Stainless Steel, Lindsay

Control Rod and Linkage

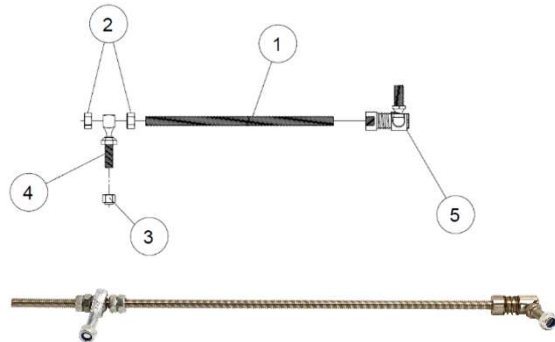

Ref.	Product Number	Description
1	03-1320-5	Rod, Linkage Control, 5/16-24 x 16", Stainless Steel
2	06-0240-9	Nut, 5/16-24, Hex, Stainless Steel
3	11-1244-0	Nut, 1/4-28, Lock, Nylon
4	11-6161-1	Joint A., Ball, Swivel, 1/4-28 x 3/4", Stainless Steel
5	11-6162-9	Joint, Ball, Quick Disconnect, Stainless Steel
**	13-3204-0	Kit, Control Rod and Linkage, S.S. (Items 1 thru 5)

### Cam Arm- Lindsay 2024 New Version



Product Number	Description
RTEC-604603	Arm, Lindsay Tower Box Using

### Cam Shaft - Lindsay 2024 New Version



Product Number	Description
RTEC-365775	Cam, Lindsay Tower Box Using

### Tower Box Shield – Lindsay 2024 Version



Product Number	Description
RTEC-642082	Tower Box Shield Only, Lindsay, Includes SS Clamps and Decal.

### Tower Box Base – Lindsay 2024 Version



Product Number	Description
RTEC-643429	Tower Box Base Only, Lindsay

### Tower Box Cover - Valley



Product Number	Description
RTEC-9311146	Tower Box Cover Only, Valley, Includes SS Clamps and Decal

### Surge Suppressor



Product Number	Description
RTEC-315663	Surge Suppressor

### AC Contactor



Product Number	Description
ACS12F7C	Original Schneider, 12A
ACS18F7C	Original Schneider, 18A
ACS25F7C	Original Schneider, 25A
ACS38F7C	Original Schneider, 38A



Product Number	Description
AC3GCR7	Original Herm, 40A



### Micro Switch



Product Number	Description
RTEP-MS-OMS	Omron, Short Arm, Black, Z-15GW22-B
RTEP-MS-OML	Omron, Long Arm, Black, Z-15GW2-B



Product Number	Description
RTEC-MS-HW01BRS	HoneyWell, Short Arm, Brown BZ-3RW8995518-PC2-S
RTEC-MS-HW03BLS	HoneyWell, Short Arm, Black BA-2RV22-A2
RTEC-MS-HW04BLL	HoneyWell, Long Arm, Black BZ-7RW82132T-S





# JOIN RAINTEK



Scan this QR  
code to go  
view our  
website and  
get more  
information.

**SAVE WATER, SAVE ENERGY,  
SAVE LABOR AND DO A BETTER  
JOB OF IRRIGATION WITH  
RAINTEK PRODUCTS.**



## RAINTEK

No.199, Tongji Road, Jiangbei District, Ningbo, China

Tel.: +86 574 87878639 / Fax.: +86 574 88856679

[sales@raintekglobal.com](mailto:sales@raintekglobal.com) / [raintekglobal.com](http://raintekglobal.com)

WARRANTY & DISCLAIMER: RainTek products are warranted for one year from date of original sale to be free of defective materials and workmanship when used within the working specifications for which the product was designed and under normal use and service. The manufacturer assumes no responsibility for installation, removal or unauthorized repair. The manufacturer's liability under this warranty is limited solely to replacement or repair of defective parts, and the manufacturer will not be liable for any crop or other consequential damages resulting from any defects in design or breach of warranty. THIS WARRANTY IS EXPRESSLY IN LIEU OF ALL OTHER WARRANTIES, EXPRESS OR IMPLIED, INCLUDING THE WARRANTIES OF MERCHANTABILITY AND FITNESS FOR PARTICULAR PURPOSES AND OF ALL OTHER OBLIGATIONS OR LIABILITIES OF MANUFACTURER. No agent, employee or representative of the manufacturer has authority to waive, alter or add to the provisions of warranty, nor to make representations or warranty not contained herein.